

## APP



Google Play and the Google Play logo are trademarks of Google Inc.



Apple and the Apple logo are trademarks of Apple Inc.



Download the soundcore app to adjust EQ settings, experience Gaming Mode, customize touch controls, update firmware, and explore more features. If your earbuds cannot connect with the soundcore app, try re-installing the app or updating it to the latest version available in your mobile app store. Download the app via <http://dl-soundcore.soundcore.com/qcdl?flow=soundcore>

## OVERVIEW

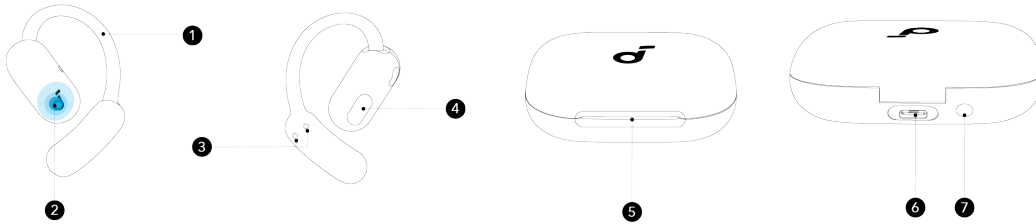

1. Adjustable Ear Hook
2. Touch Area
3. Charging Contactors
4. Sound Outlet
5. LED Light Strip
6. USB-C Charging Port
7. Charging Case Button

## POWERING ON & PAIRING

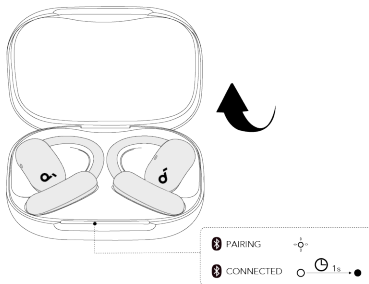

1. Open the charging case. The earbuds will automatically power on and enter Bluetooth pairing mode.



2. Select "**soundcore AeroFit 2**" on your device's Bluetooth list to connect. During pairing, the LED light strip on the charging case will start flashing. Once the pairing is successful, the LED light strip will stay on for 1 second before turning off.



Once connected, the earbuds will automatically reconnect to your device every time you open the charging case, as long as you haven't deleted the pairing history from your device.

## DUAL CONNECTIONS

To connect your earbuds with two Bluetooth devices at the same time, there are two methods:

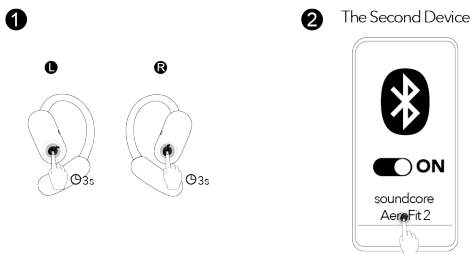

### Method 1: Manually Pair with the Second Device

While wearing the earbuds, press and hold the touch control areas on both earbuds for 3 seconds until you hear a sound prompt for pairing mode. You can then proceed to pair with the second device.

If your earbuds have been connected to two devices, remove at least one before pairing with a new device.

### Method 2: Use the soundcore App

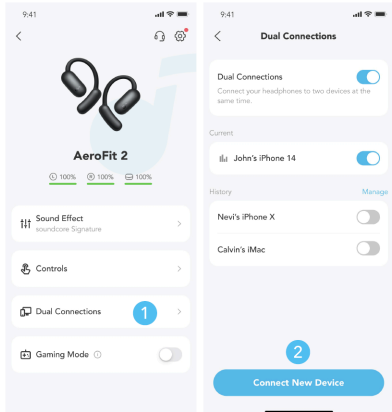

In the soundcore app, tap **Dual Connections** on the main interface, then proceed to **Connect New Device**.

Dual Connections feature is enabled by default.

## MANUAL PAIRING

To manually enter Bluetooth pairing mode:

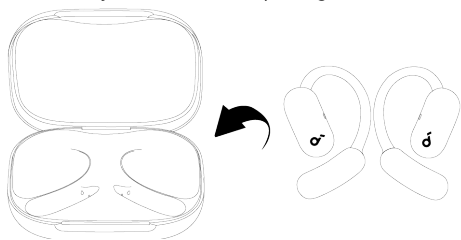

1. Return the earbuds to the charging case.

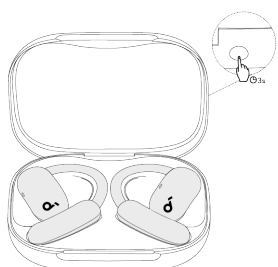

2. Leave the case open, then press and hold the charging case button for 3 seconds.



3. The earbuds will enter pairing mode. Proceed to pair with your device.

## WEARING

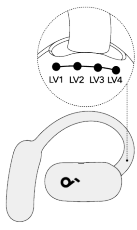

1. Pick up the earbuds and slide the ear hooks all the way to the LV4 position, which offers the largest fit.

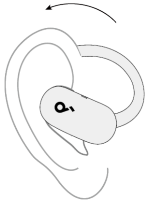

2. Rotate the ear hooks along your outer ear for proper positioning.

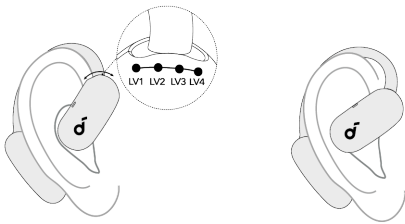

3. After putting on the earbuds, you can slide the ear hooks back and forth between four levels until you find the most comfortable and secure fit.

### Ear Hook Position Guide

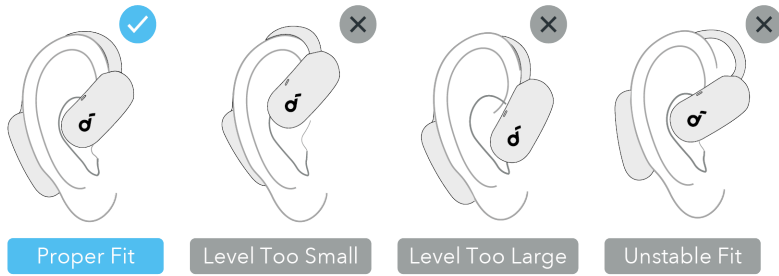

### How to Clean



Charging Contacts

After each use, wipe the earbuds with a soft, dry cloth and clean the charging contacts with a cotton swab to prevent charging and power-off issues caused by sweat accumulation.

### SOUND EFFECTS

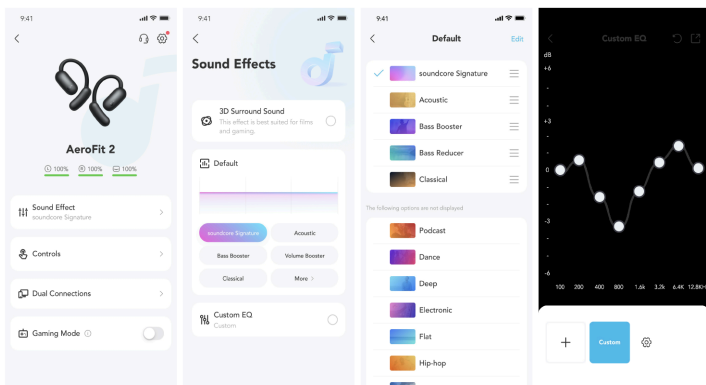

In the soundcore app, the default sound effect is "soundcore Signature", a special preset recommended by the soundcore team. We offer 22 EQ presets for different scenarios, which you can switch based on your preferences.

Additionally, you can create your own sound profile by adjusting eight sliders on the "Custom Equalizer" page.

## CONTROLS

### Using Dual Earbuds

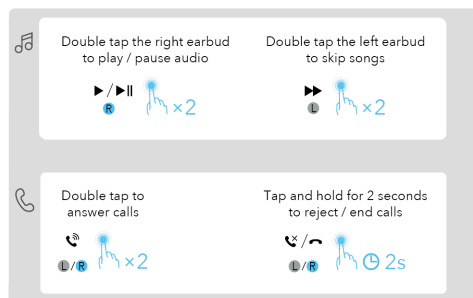

### Using Single Earbud

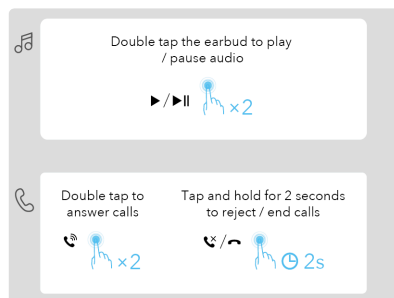

		Using Dual Earbuds	Using Single Earbud
🎵	Play / Pause Audio	Double tap (R)	Double tap
	Play the Previous Track	Customize in the soundcore app	/
	Play the Next Track	Double tap (L)	
☎️	Answer a Call	Double tap (L/R)	Double tap
	Reject a Call / End a Call	Tap and hold for 2 seconds (L/R)	Tap and hold for 2 seconds
🔊	Increase Volume	Customize in the soundcore app	Customize in the soundcore app
	Decrease Volume		
🗣️	Activate Voice Assistant	Customize in the soundcore app	Customize in the soundcore app

## Customize Touch Controls on soundcore App

Note: The UI images are for illustration purposes only. Actual display contents may vary based on the software version.

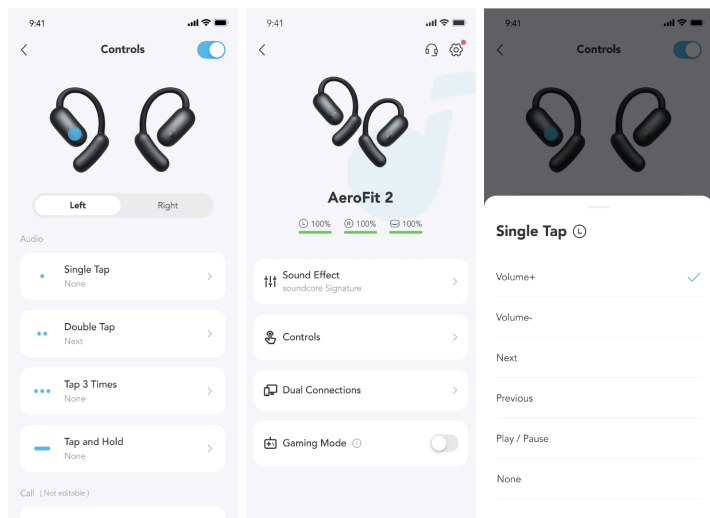

Tap **Controls** on the home page to personalize touch control actions for either the left or right earbud. **You can adjust actions such as increasing/decreasing volume, switching songs, playing/pausing audio, and activating the voice assistant.**

## CHARGING

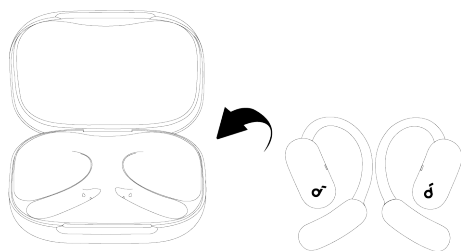

1. Place the earbuds in the charging case and close it.

- Ensure the earbuds and the USB-C charging port are fully dry before charging.

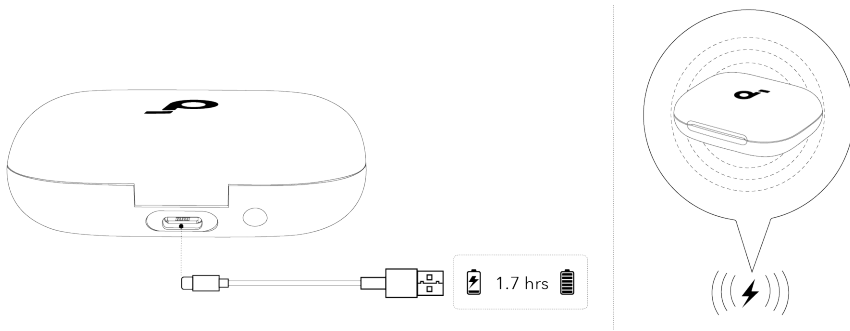

2. Connect the charging case to a power supply using the provided USB-C charging cable. Alternatively, for wireless charging, place the charging box at the center of your wireless charger.

- Recharging the charging case takes 1.7 hours via cable and 2.6 hours via wireless charging.

## POWERING OFF

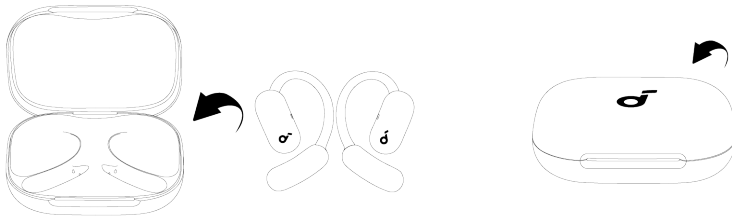

To power off, return both earbuds to the charging case and close the case.

 The earbuds will automatically power off after 30 minutes if they are not connected. The duration can be customized in the soundcore app.

## RESET

Reset the earbuds if they have issues pairing with each other or with other devices.

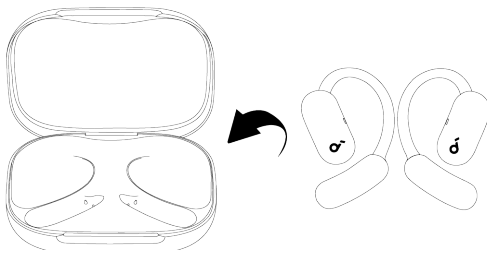

1. Return the earbuds to the charging case and leave the case open.

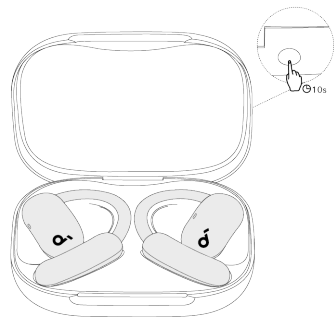

2. Press and hold the charging case button for 10 seconds until the LED light strip flashes white quickly three times, indicating a successful reset.

## LED LIGHT GUIDE

### Checking the Battery Level

When you open the charging case, the LED light strip will indicate the remaining battery level of the case.

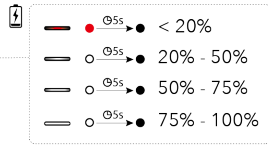
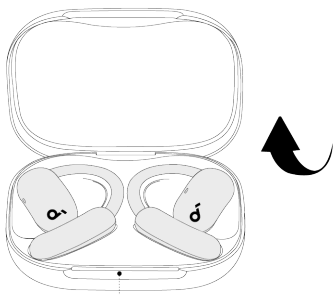

### Checking the Charging Status

When you connect the charging case to a power source, the LED light strip will display the charging status:

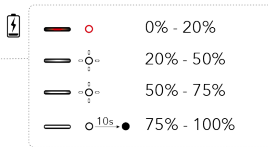
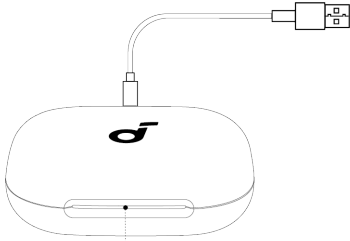

### FIRMWARE UPDATE

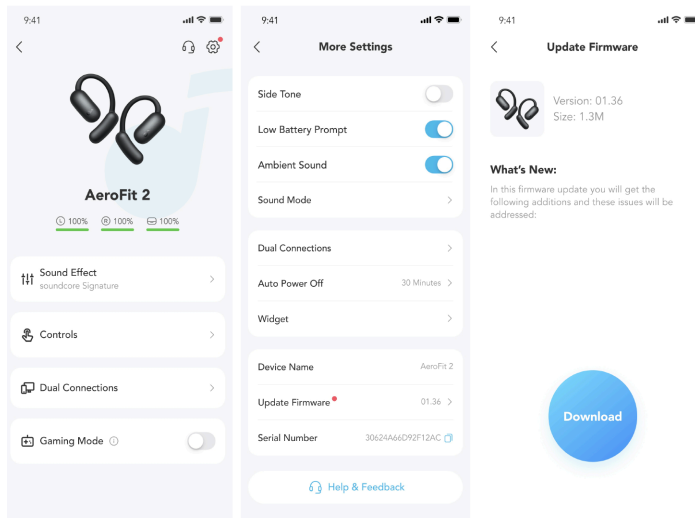

You will be notified once a new firmware version is detected when the earbuds are connected to the app. Ensure the earbuds are in the charging case and the case remains open until the firmware update is complete. Avoid using the earbuds during the update.

### SPECS

Specifications are subject to change without notice.

Input	5V ⚡ 1.2A
Output	5V ⚡ 0.42A (0.21A per port)
Battery capacity	750mAh
Charging time	Earbuds: within 1 hour Charging case: Wired charging time: 1.7 hours to fully charge the charging case, 2.2 hours to fully charge the charging case and the earbuds Wireless charging time: 2.6 hours to fully charge the charging case and the earbuds.
Driver unit	20*11.5mm
Frequency response	20~20kHz (20~40kHz when LDAC is enabled)
Impedance	16Ω
Waterproof rating (earbuds)	IP55
Bluetooth version	5.4

## Customer Service



service@soundcore.com  
support.me@soundcore.com (For Middle East and Africa Only)  
support@anker.com (日本)  
+1 (800) 988 7973 (US/Canada)  
+44 (0) 1604 936200 (UK)  
+49 (0) 69 9579 7960 (DE)  
03 4455 7823 (日本)  
+86 400 0550 036 (中国)  
+82 1666-8470 (한국)  
+971 8000320817 (UAE)  
+966 8008500030 (KSA)  
+965 22069086 (Kuwait)  
+20 8000000826 (Egypt)  
+61 3 8331 4800 (Australia)  
+90 (850) 460 14 14 (Türkiye)  
+8 (800) 511-86-23 (Russia)  
000-8000-504-414 (India)



Note: The 'x' of SN Code: xxxxxxxxxxxxxxxx is a variable, see below table.

Variable 'x'	Range of variable	Content
Eighth	8,9,A,B,C...	Denotes the year, 8 means 2018, 9 means 2019, A means 2020, B means 2021, C means 2022, and so on.
Ninth and tenth	01,02,03...	Denotes weeks, 01 means the first week in this year, 02 means the secondary week in this year, and so on.
Eleventh	1-7	Denotes date, 1 means Monday, 2 means Tuesday..., 7 means Sunday and so on.
The last five	00001-99999	Denotes serial No.

Hereby, Anker Innovations Limited declares that this device is in compliance with The Product Security and Telecommunications Infrastructure (Security Requirements for Relevant Connectable Products) Regulations 2023. For the Statement of Compliance, visit the website: <https://uk.soundcore.com/pages/psti-related>.

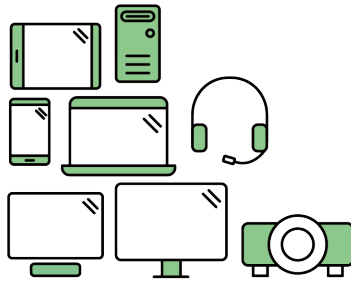

## Say hello to a more sustainable product

IT products are associated with a wide range of sustainability risks throughout their life cycle. Human rights violations are common in the factories. Harmful substances are used both in products and their manufacture. Products can often have a short lifespan because of poor ergonomics, low quality and when they are not able to be repaired or upgraded.

**This product is a better choice.** It meets all the criteria in TCO Certified, the world's most comprehensive sustainability certification for IT products. Thank you for making a responsible product choice, that help drive progress towards a more sustainable future!

Criteria in TCO Certified have a life-cycle perspective and balance environmental and social responsibility. Conformity is verified by independent and approved verifiers that specialize in IT products, social responsibility or other sustainability issues. Verification is done both before and after the certificate is issued, covering the entire validity period. The process also includes ensuring that corrective actions are implemented in all cases of factory non-conformities. And last but not least, to make sure that the certification and independent verification is accurate, both TCO Certified and the verifiers are reviewed regularly.

### Want to know more?

Read information about TCO Certified, full criteria documents, news and updates at [tcocertified.com](https://www.tcocertified.com). On the website you'll also find our Product Finder, which presents a complete, searchable listing of certified products.